

Return address: Postbus 79092, 1070 NC Amsterdam

Contact:

Katarina Nikolic

Reference:

To residents and business owners in Kop Zuidas

Date:

02/04/2026

Subject: **Planting trees on Gaasterlandstraat**

Dear resident, business owner or other interested party,

Between Monday 6 April and Friday 24 April, we will be planting seven trees on Gaasterlandstraat. In this letter, we would like to inform you about these activities and how they may affect you.

### What are we going to do?

The activities consist of the installation of a drainage system (which will enable us to suppress the local groundwater level temporarily) and the planting of trees. The activities will take place on the section between Eemlandstraat and Gelrestraat. The installation of the drainage system requires that we remove a strip of pavement on the side of SUD and Zuidoever. Subsequently, we will plant the trees in soil specifically made for trees. At the end of the letter you will find a map showing the locations of the new trees.

### Disruption and accessibility

These activities may temporarily cause some inconvenience. We work in phases and deploy pragmatic solutions, like placing steel road plates[?] to keep the parking garage and surrounding area accessible as much as possible. Pedestrians can keep using the pavement via a passageway. The lane on Gaasterlandstraat will remain open to car traffic (albeit for local destinations only), but it will be narrowed temporarily. The temporary traffic situation will be clarified by traffic signs. The activities will take place from Monday to Friday between 7:00 am and 7:00 pm. Supply trucks will avoid the morning and afternoon rush hours.

### Parking garage

To keep the parking garage accessible as much as possible, we carry out the activities in phases. The execution consists of two phases, phase 1A and phase 1B. During Phase 1A, the construction work will take place on the west side of the parking garage. During this phase, the parking garage's entrance and exit on the east side can be used. During Phase 1B, the activities will happen on the east side, when the garage will be accessible via the entrance and exit on the west side. This approach ensures that the parking garage does not have to close at any time during the execution of this work.

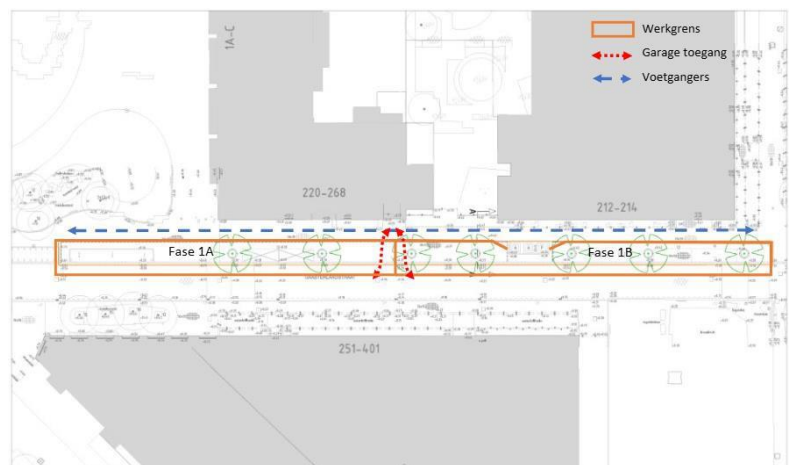

Figure 1; Phasing on Gaasterlandstraat

### Waste containers

The waste containers will be in use throughout and waste collection will happen according to the regular schedule. If necessary, the activities will be suspended briefly when the containers are emptied.

### More information

We hope this letter has given you all the information you needed. We do our best to keep you posted on the progress of project in Kop Zuidas. More information about the developments in your area can be found on <https://zuidas.nl/en>. Do you have any questions in relation to this letter? Then please contact us via <https://zuidas.nl/en/contact> or – by telephone – on 0800 – 5065. In addition, our Information Centre in the WTC Building (59 Strawinskylaan) is open every Monday to Thursday between 10:00 am and 4:00 pm. Via our website, you can also sign up for the Zuidas newsletter and register for the monthly guided tours.

Kind regards,



Thijs Koolmees

Project Manager Kop  
Zuidas



Figure 2; Location of trees on Gaasterlandstraat